



# Certificate of Accreditation

## Sewage Management Facility

### Septic Tanks & Collection Wells

*This Certificate of Accreditation is issued by the Secretary of the NSW Ministry of Health pursuant to Clause 41(1) of the Local Government (General) Regulation 2005.*

**Manufacturer:** *Bissett Company Pty Ltd t/a Allcast Precast*

**Of:** *40 Hill St, Woombye, QLD, 4559*

*The Allcast Precast Septic Tanks and Collection Wells as described in the following Schedule have been accredited as sewage management facilities for use in single domestic premises in NSW.*

*A/Director, Environmental Health  
for Secretary (delegation PH335)*

**Issued:** *20 / Feb / 2023*

**Certificate No:** *STCW 014*

**Expires:** *31 December 2025*



## **Accreditation Schedule**

*The Certificate of Accreditation applies to the following  
Septic Tanks and Collection Wells*

<b>Model</b>	<b>Description</b>	<b>Size</b>
Septic Tank	Vertical axis type, cylindrical pre cast, steel fibre reinforced concrete with lid, access cover, inlet, and outlet fittings (with partition). Burial depth of the tank lid is restricted to 0 mm	3050L 4000L 4250L 4450L 7000L
Collection Well	Vertical axis type, cylindrical pre cast, steel fibre reinforced concrete. Certification applies only to the construction of the tank, lid, access cover and inlet fitting. It does not include the internal fittings or partitions Burial depth of the tank lid is restricted to 0 mm	3200L 4400L 4650L 7000L
Septic Tank and Collection Well	Vertical axis cylindrical precast tank with reinforcing mesh. Burial depth of the tank lid is restricted to 0 mm	7000 L

**General Notes:**

- 1.1 These drawings are to be read in conjunction with all other consultant drawings and specifications
- 1.2 All dimensions shall be checked with Allcast precast representative
- 1.3 Tank Design for Exclusive use by Allcast Precast only
- 1.4 Allcast Precast Septic Tanks are Certified and Tested by SAI Global to AS/NZS 1546.1:2008 – On-site domestic wastewater treatment units- Septic Tanks

**2- Loadings:**

- 2.1 Standard Lids must remain at ground level with no soil cover. 500kg capacity
- 2.2 Speak to Allcast about below ground options or riser rings.

**3- Foundations:**

- 3.1 Foundation material is to be a 75mm layer of screeded 5-10mm gravel
- 3.2 Tank backfill to be free draining and placed to Allcast Precast backfill specifications

**4.0 Reinforced Concrete:**

- 4.1 Concrete shall have a characteristic compressive strength after 28 days of no less than : 40 MPa
- 4.2 All concrete shall be mechanically vibrated. Vibrator shall not be used to spread concrete
- 4.3 All reinforcement to be 500Mpa minimum yield strength
- 4.4 All reinforcing fibre to be 600Mpa minimum yield strength

**ACCREDITED**

**20 FEB 2023**

**NSW MINISTRY OF HEALTH**



PHONE :: (07) 5442 2522  
 FAX :: (07) 5442 2479  
 POST :: PO Box 100, Woombye Q 4559  
 FACTORY :: 40 Hill St, Woombye Q 4559  
 WEB :: www.allcastprecast.com.au



**STANDARDSMARK LICENCE**

Manufactured to:  
 AS/NZS 1546.1:2008  
 On-site domestic wastewater treatment units - Septic tanks



**3,050 LITRE SEPTIC TANK**  
 TOTAL WEIGHT - 2.2 T  
 GENERAL ARRANGEMENT SHOWN  
 INSERTS CAN BE CHANGED TO SUIT REQUIREMENTS

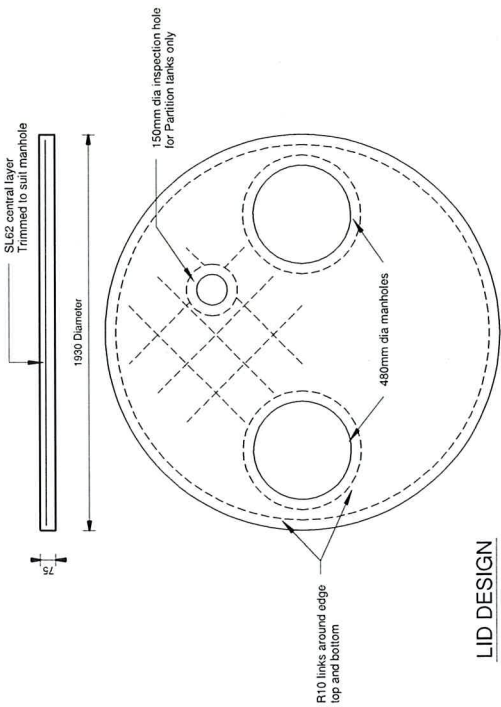
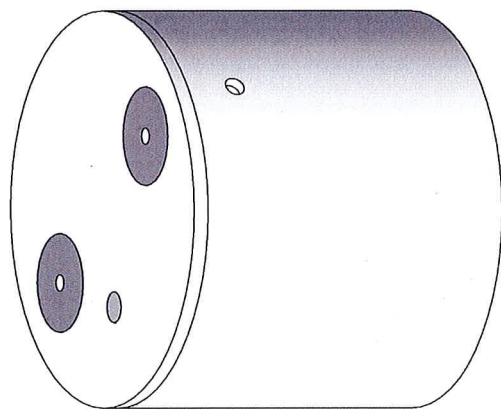

**LID DESIGN**

1 : 25

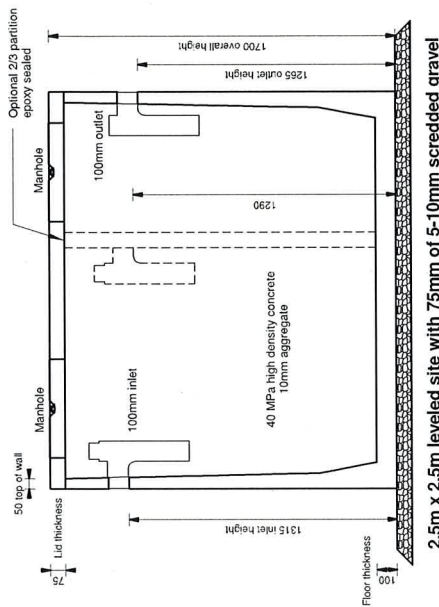

**TANK DESIGN**

1 : 25

**ALSO AVAILABLE AT ALLCAST PRECAST**

- Riser rings 400mm- 1500mm
- 4 Way Baffled Distribution boxes
- Outlet filters
- Partition walls
- Underground lids and manhole risers
- Wastewater treatment systems
- Pump wells
- Collection wells

**General Notes:**

- 1.1 These drawings are to be read in conjunction with all other consultant drawings and specifications
- 1.2 All dimensions shall be checked with Allcast precast representative
- 1.3 Tank Design for Exclusive use by Allcast Precast only
- 1.4 Allcast Precast Septic Tanks are Certified and Tested by SAI Global to AS/NZS 1546.1:2008 – On-site domestic wastewater treatment units- Septic Tanks

**2- Loadings:**

- 2.1 Standard Lids must remain at ground level with no soil cover. 500kg capacity
- 2.2 Speak to Allcast about below ground options or riser rings.

**3- Foundations:**

- 3.1 Foundation material is to be a 75mm layer of screeded 5-10mm gravel

- 3.2 Tank backfill to be free draining and placed to Allcast Precast backfill specifications

**4.0 Reinforced Concrete:**

- 4.1 Concrete shall have a characteristic compressive strength after 28 days of no less than : 40 MPa
- 4.2 All concrete shall be mechanically vibrated. Vibrator shall not be used to spread concrete
- 4.3 All reinforcement to be 500Mpa minimum yield strength
- 4.4 All reinforcing fibre to be 600Mpa minimum yield strength

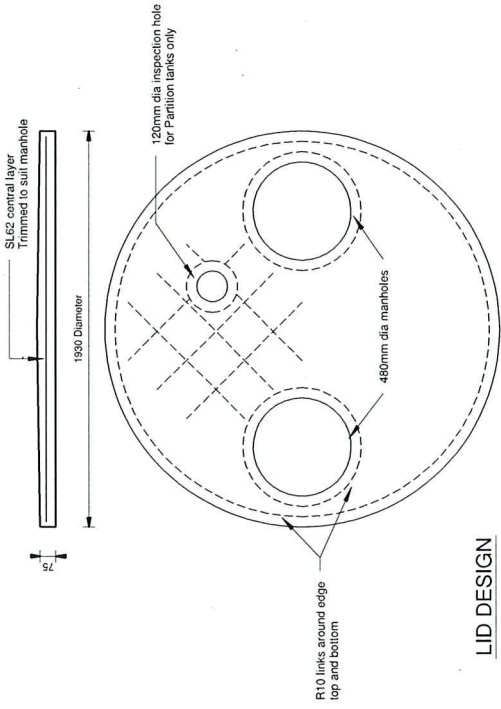
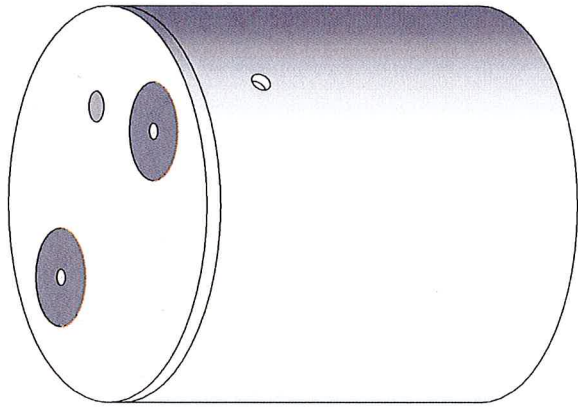
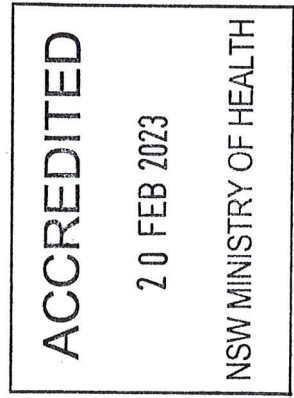

**LID DESIGN**

1 : 25

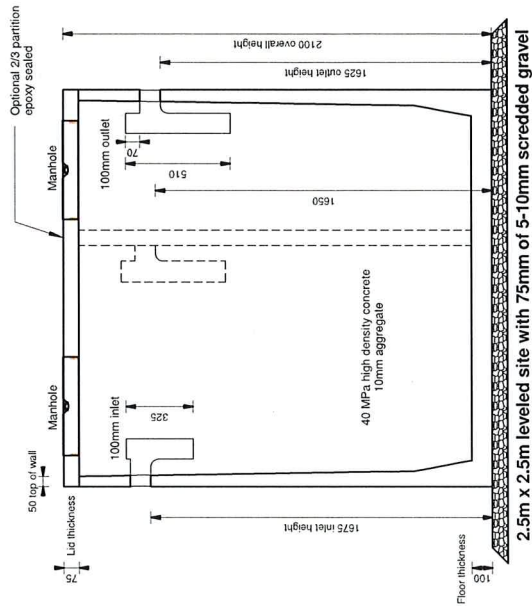

**TANK DESIGN**

1 : 25

**ALSO AVAILABLE AT ALLCAST PRECAST**

- Riser rings 400mm- 1500mm
- 4 Way Baffled Distribution boxes
- Outlet filters
- Partition walls
- Underground lids and manhole risers
- Wastewater treatment systems
- Pump wells
- Collection wells



PHONE :: (07) 5442 2522  
 FAX :: (07) 5442 2479  
 POST :: PO Box 100, Woombye Q. 4559  
 FACTORY :: 40 Hill St, Woombye Q. 4559  
 WEB :: www.allcastprecast.com.au



STANDARDSMARK  
 LICENCE



Manufactured to:  
 AS/NZS 1546.1:2008  
 On-site domestic wastewater  
 treatment units - Septic tanks

**4,000 LITRE SEPTIC TANK**  
 TOTAL WEIGHT - 2.4 T  
 GENERAL ARRANGEMENT SHOWN  
 INSERTS CAN BE CHANGED TO SUIT REQUIREMENTS

**General Notes:**

- 1.1 These drawings are to be read in conjunction with all other consultant drawings and specifications
- 1.2 All dimensions shall be checked with Allcast precast representative
- 1.3 Tank Design for Exclusive use by Allcast Precast only
- 1.4 Allcast Precast Septic Tanks are Certified and Tested by SAI Global to AS/NZS 1546.1:2008 – On-site domestic wastewater treatment units- Septic Tanks

**2- Loadings:**

- 2.1 Standard Lids must remain at ground level with no soil cover. 500kg capacity
- 2.2 Speak to Allcast about below ground options or riser rings.

**3- Foundations:**

- 3.1 Foundation material is to be a 75mm layer of screeded 5-10mm gravel

- 3.2 Tank backfill to be free draining and placed to Allcast Precast backfill specifications

**4.0 Reinforced Concrete:**

- 4.1 Concrete shall have a characteristic compressive strength after 28 days of no less than : 40 MPa
- 4.2 All concrete shall be mechanically vibrated. Vibrator shall not be used to spread concrete
- 4.3 All reinforcement to be 500Mpa minimum yield strength
- 4.4 All reinforcing fibre to be 600Mpa minimum yield strength

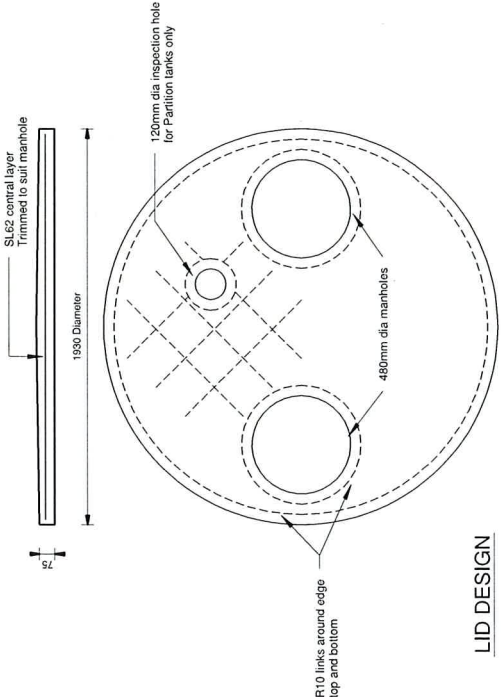
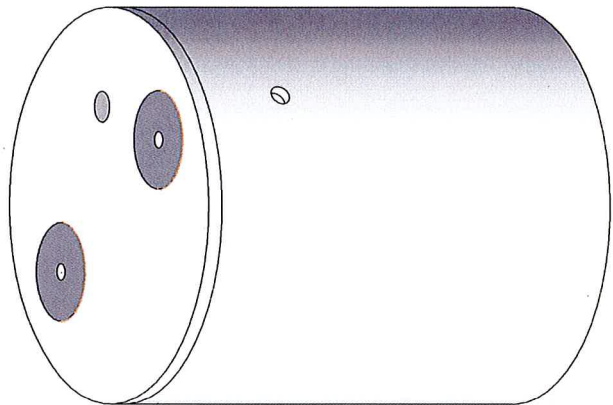
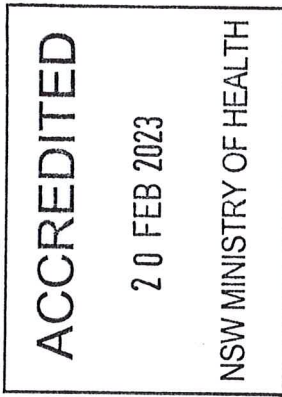

**LID DESIGN**

1 : 25

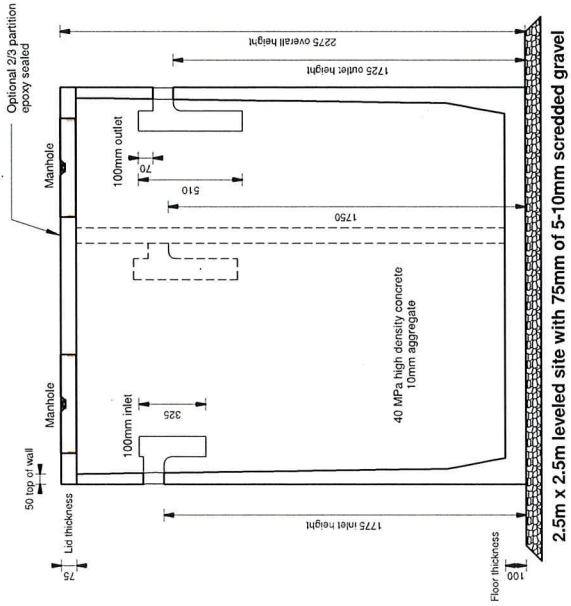

**TANK DESIGN**

1 : 25

**ALSO AVAILABLE AT ALLCAST PRECAST**

- Riser rings 400mm- 1500mm
- 4 Way Baffled Distribution boxes
- Outlet filters
- Partition walls
- Underground lids and manhole risers
- Wastewater treatment systems
- Pump wells
- Collection wells



PHONE : (07) 5442 2522  
 FAX : (07) 5442 2479  
 POST : PO Box 100, Woombye Q 4559  
 FACTORY : 40 Hill St, Woombye Q 4559  
 WEB : www.allcastprecast.com.au



STANDARDSMARK  
 LICENCE

Manufactured to:  
 AS/NZS 1546.1:2008

On-site domestic wastewater  
 treatment units - Septic tanks



**4,250 LITRE SEPTIC TANK**  
 TOTAL WEIGHT - 2.8 T  
 GENERAL ARRANGEMENT SHOWN  
 INSERTS CAN BE CHANGED TO SUIT REQUIREMENTS

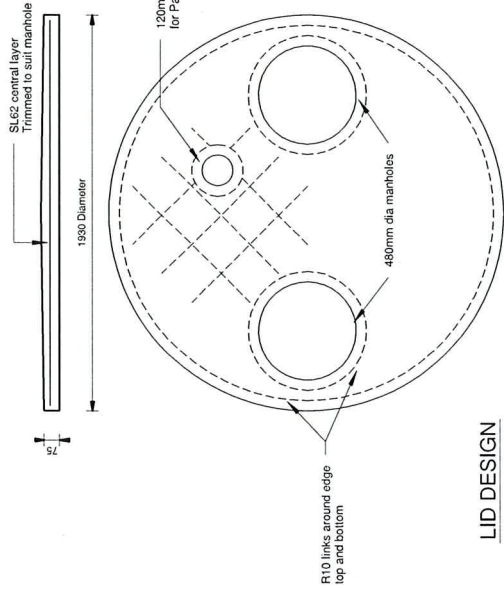
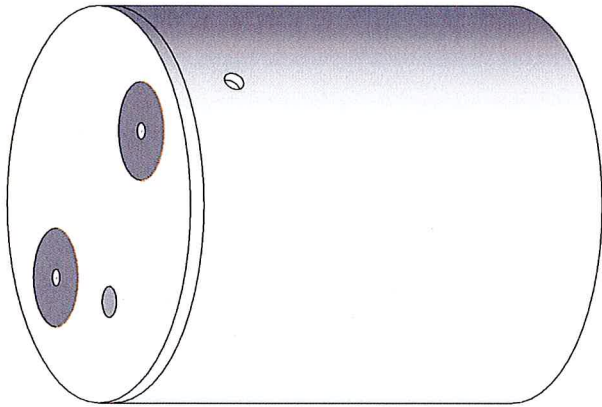

**LID DESIGN**

1 : 25

**General Notes:**

- 1.1 These drawings are to be read in conjunction with all other consultant drawings and specifications
- 1.2 All dimensions shall be checked with Allcast precast representative
- 1.3 Tank Design for Exclusive use by Allcast Precast only
- 1.4 Allcast Precast Septic Tanks are Certified and Tested by SAI Global to AS/NZS 1546.1:2008 – On-site domestic wastewater treatment units- Septic Tanks

**2- Loadings:**

- 2.1 Standard Lids must remain at ground level with no soil cover. 500kg capacity
- 2.2 Speak to Allcast about below ground options or riser rings.

**3- Foundations:**

- 3.1 Foundation material is to be a 75mm layer of screeded 5-10mm gravel

- 3.2 Tank backfill to be free draining and placed to Allcast Precast backfill specifications

**4.0 Reinforced Concrete:**

- 4.1 Concrete shall have a characteristic compressive strength after 28 days of no less than : 40 MPa
- 4.2 All concrete shall be mechanically vibrated. Vibrator shall not be used to spread concrete
- 4.3 All reinforcement to be 500Mpa minimum yield strength
- 4.4 All reinforcing fibre to be 600Mpa minimum yield strength

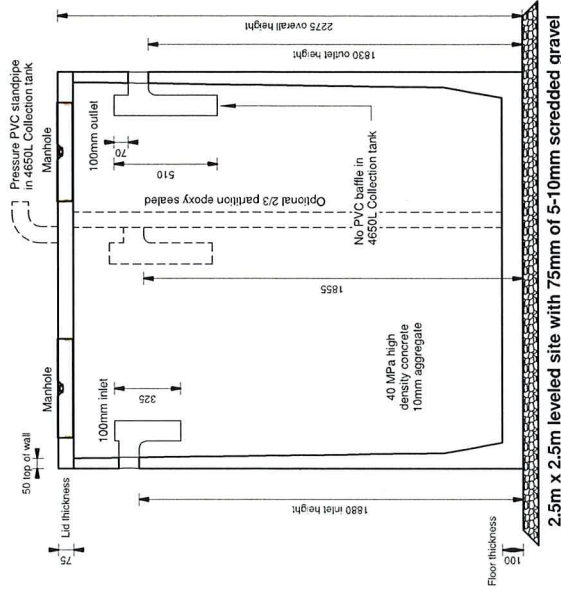
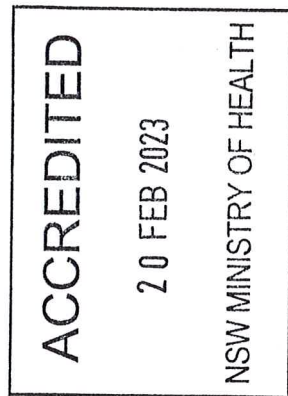

**TANK DESIGN**

1 : 25

**ALSO AVAILABLE AT ALLCAST PRECAST**

- Riser rings 400mm- 1500mm
- 4 Way Baffled Distribution boxes
- Outlet filters
- Partition walls
- Underground lids and manhole risers
- Wastewater treatment systems
- Pump wells
- Collection wells



PHONE :: (07) 5442 2522  
 FAX :: (07) 5442 2479  
 POST :: PO Box 100, Woombye Q. 4559  
 FACTORY :: 40 Hill St, Woombye Q. 4559  
 WEB :: www.allcastprecast.com.au



STANDARDSMARK  
 LICENCE

Manufactured to:  
 AS/NZS 1546.1:2008  
 On-site domestic wastewater  
 treatment units - Septic tanks



**4,450 LITRE SEPTIC TANK/4,650 LITRE COLLECTION**  
 TOTAL WEIGHT - 2.8 T  
 GENERAL ARRANGEMENT SHOWN  
 INSERTS CAN BE CHANGED TO SUIT REQUIREMENTS

**General Notes:**

- 1.1 These drawings are to be read in conjunction with all other consultant drawings and specifications
- 1.2 All dimensions shall be checked with Allcast precast representative
- 1.3 Tank Design for Exclusive use by Allcast Precast only
- 1.4 Allcast Precast Septic Tanks are Certified and Tested by SAI Global to AS/NZS 1546.1:2008 – On-site domestic wastewater treatment units- Septic Tanks

**2- Loadings:**

- 2.1 Standard Lids must remain at ground level with no soil cover: 500kg capacity
- 2.2 Speak to Allcast about below ground options or riser rings.

**3- Foundations:**

- 3.1 Foundation material is to be a 75mm layer of screeded 5-10mm gravel
- 3.2 Tank backfill to be free draining and placed to Allcast Precast backfill specifications

**4.0 Reinforced Concrete:**

- 4.1 Concrete shall have a characteristic compressive strength after 28 days of no less than : 40 MPa
- 4.2 All concrete shall be mechanically vibrated. Vibrator shall not be used to spread concrete
- 4.3 All reinforcement to be 500Mpa minimum yield strength
- 4.4 All reinforcing fibre to be 600Mpa minimum yield strength

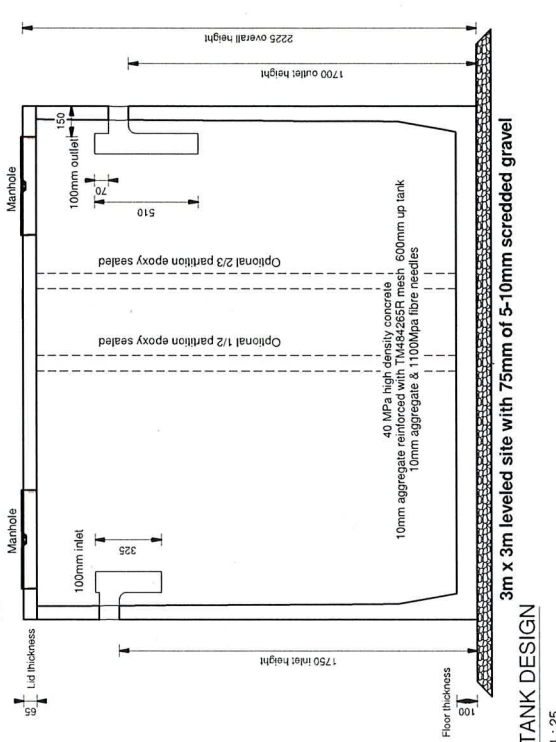
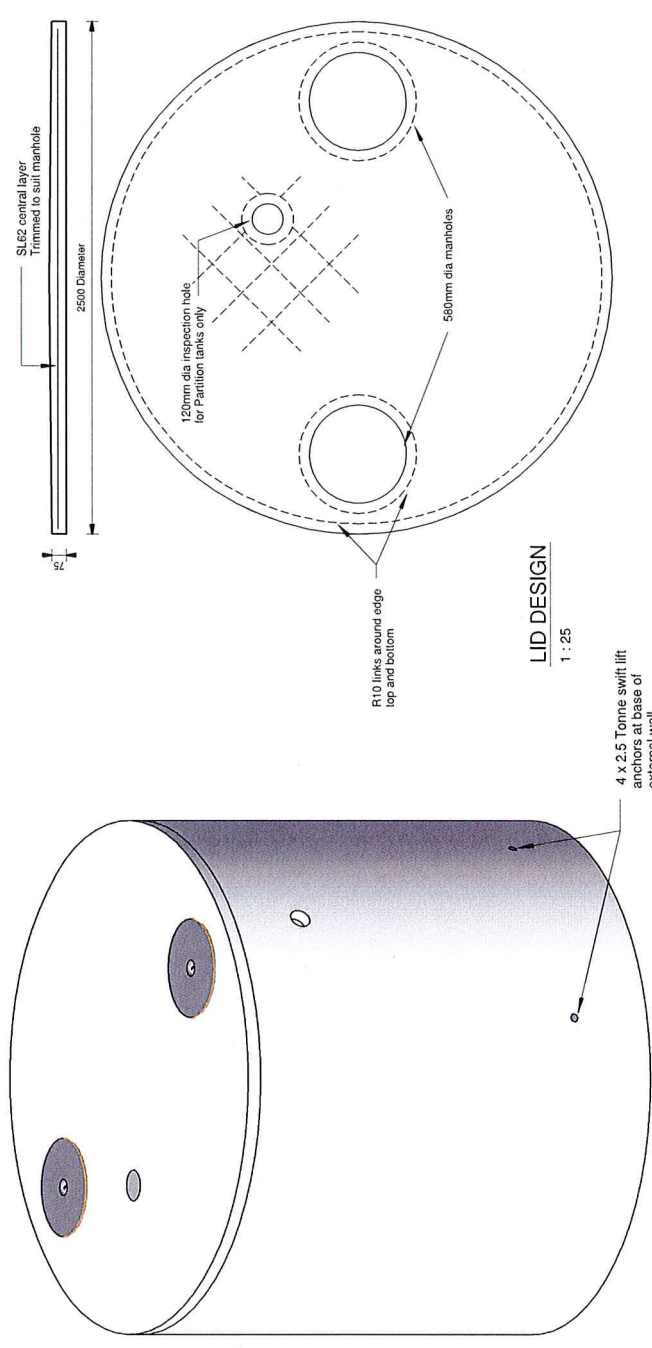
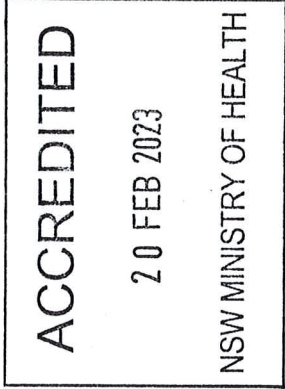

**ALSO AVAILABLE AT ALLCAST PRECAST**

- Riser rings 400mm- 1500mm
- 4 Way Baffled Distribution boxes
- Outlet filters
- Partition walls
- Underground lids and manhole risers
- Wastewater treatment systems
- Pump wells
- Collection wells



PHONE :: (07) 5442 2522  
 FAX :: (07) 5442 2479  
 POST :: PO Box 100, Woombye Q.4559  
 FACTORY :: 40 Hill St, Woombye Q.4559  
 WEB :: www.allcastprecast.com.au



STANDARDS MARK LICENCE

Manufactured to: AS/NZS 1546.1:2008  
 On-site domestic wastewater treatment units - Septic tanks



**7,000 LITRE SEPTIC TANK**  
 TOTAL WEIGHT - 4.0 T  
 GENERAL ARRANGEMENT SHOWN  
 INSERTS CAN BE CHANGED TO SUIT REQUIREMENTS

**General Notes:**

- 1.1 These drawings are to be read in conjunction with all other consultant drawings and specifications
- 1.2 All dimensions shall be checked with Alcast precast representative
- 1.3 Tank Design for Exclusive use by Alcast Precast only
- 1.4 Alcast Precast Septic Tanks are Certified and Tested by SAI Global to AS/NZS 1546.1:2008 – On-site domestic wastewater treatment units- Septic Tanks
- 2- Loadings:
  - 2.1 Standard Lids must remain at ground level with no soil cover. 500kg capacity
  - 2.2 Speak to Alcast about below ground options or riser rings.
- 3- Foundations:
  - 3.1 Foundation material is to be a 75mm layer of screeded 5-10mm gravel
  - 3.2 Tank backfill to be free draining and placed to Alcast Precast backfill specifications
- 4.0 Reinforced Concrete:
  - 4.1 Concrete shall have a characteristic compressive strength after 28 days of no less than : 40 MPa
  - 4.2 All concrete shall be mechanically vibrated. Vibrator shall not be used to spread concrete
  - 4.3 All reinforcement to be 500Mpa minimum yield strength
  - 4.4 All reinforcing fibre to be 600Mpa minimum yield strength

**ACCREDITED**

20 FEB 2023

NSW MINISTRY OF HEALTH



PHONE :: (07) 5442 2522  
 FAX :: (07) 5442 2479  
 POST :: PO Box 100, Woombye Q. 4559  
 FACTORY :: 40 Hill St, Woombye Q. 4559  
 WEB :: www.alcastprecast.com.au



STANDARDS MARK  
 LICENCE

Manufactured to:  
 AS/NZS 1546.1:2008  
 On-site domestic wastewater  
 treatment units - Septic tanks



**7,200 LITRE COLLECTION TANK**  
 TOTAL WEIGHT - 4.0 T  
 GENERAL ARRANGEMENT SHOWN  
 INSERTS CAN BE CHANGED TO SUIT REQUIREMENTS

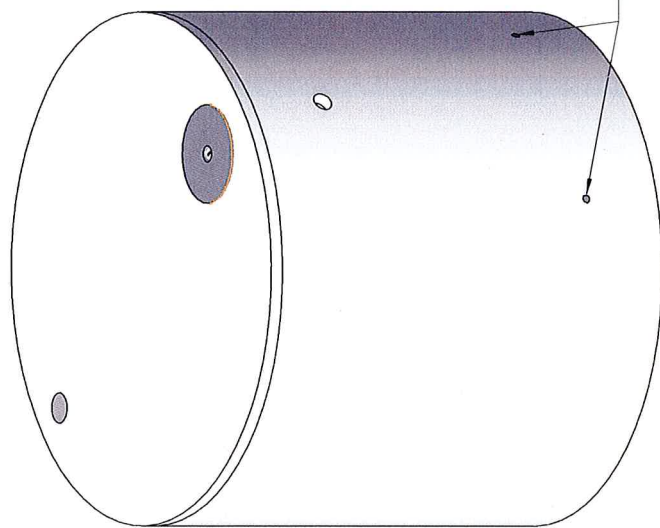
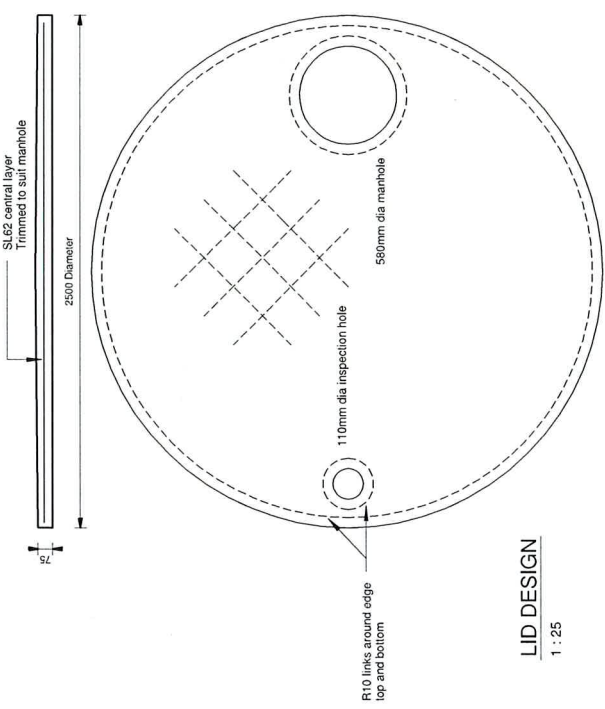

- ALSO AVAILABLE AT ALLCAST PRECAST
- Riser rings 400mm- 1500mm
  - 4 Way Baffled Distribution boxes
  - Outlet filters
  - Partition walls
  - Underground lids and manhole risers
  - Wastewater treatment systems
  - Pump wells
  - Collection wells

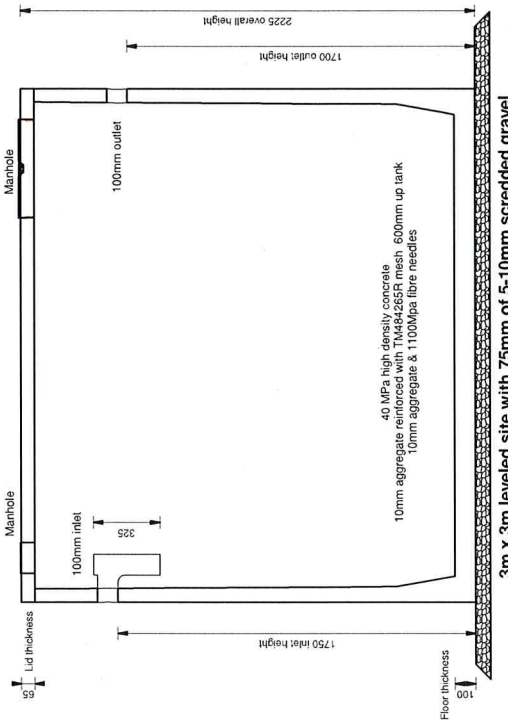



**1 - GENERAL NOTES**

1.1 - These drawings shall be read in conjunction with all other consultant drawings and specifications. Any discrepancies shall be referred to the architect or project manager for a decision before proceeding with the work. Any decision that inputs on Engineering Design shall be referred to the Engineer for confirmation of design integrity.

1.2 - Dimensions SHALL NOT be obtained by scaling off the drawings.

1.3 - All dimensions shall be checked by Builder prior to commencement of works.

1.4 - Tank Design for exclusive use by Aussie Treat only.

**2 - REINFORCED CONCRETE**

2.1 - All work shall be in accordance with all current Australian Standards as a MINIMUM work standard.

2.2 - Concrete shall have a characteristic compressive strength after 28 days of not less than : 40 MPa.

2.3 - All concrete shall be mechanically vibrated. Vibrator shall not be used to spread concrete.

2.4 - All reinforcement shall be supported on plastic chairs, generally at not greater than 800mm centres in both directions. Bars shall be tied at alternate intersections.

2.5 - Concrete to have a maximum aggregate size of 10mm and water/cement ratio of not greater than 0.65.

2.6 - The maximum permissible transport time for concrete between batching and placement on site shall be in accordance with the following table.

AMBIENT AIR TEMPERATURE	MAX. BATCHING TO PLACEMENT TIME
10°-24°C	120 minutes
25°-27°C	90 minutes
28°-30°C	60 minutes
31°-33°C	45 minutes
34°-36°C	30 minutes
37°C+	No placement of concrete unless chilled water or ice in mix

2.6 - All reinforcement shall be supplied by a registered manufacturer with an approved and certifier quality assurance program in place. All reinforcement is to comply with the requirements of AS 1302, AS 1303 and AS 1304 as applicable.

2.7 - All reinforcement is to be placed free from oil, grease or other surface coatings which may impair bond to concrete.

2.8 - All reinforcement to be 500 MPa minimum yield unless noted otherwise.

2.9 - Reinforcement shall not be welded without written approval from the Engineer.

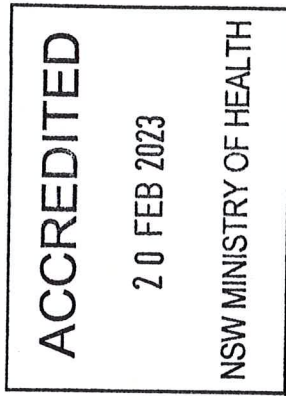

**TREATMENT SYSTEM TANK**  
GENERAL ARRANGEMENT SHOWN  
CUSTOM FITTINGS BY REQUEST

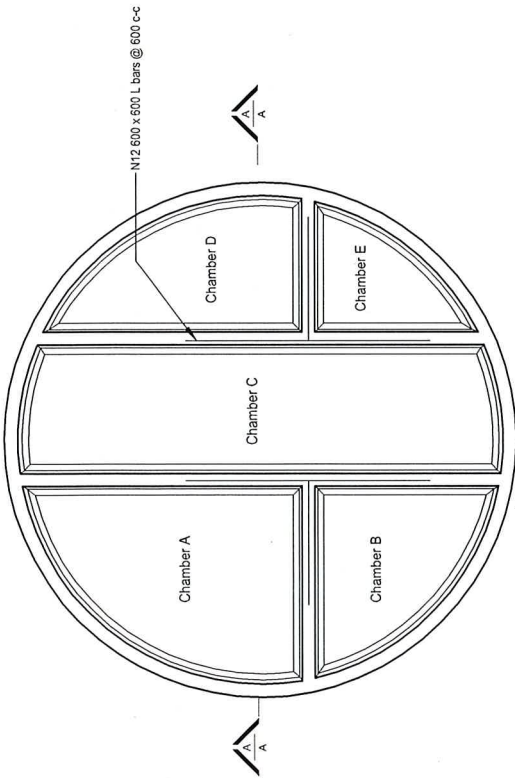
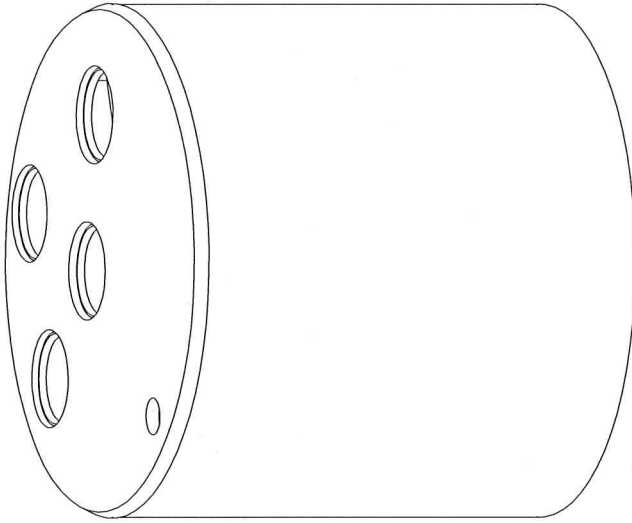

**Tank Plan**  
Scale 1:25

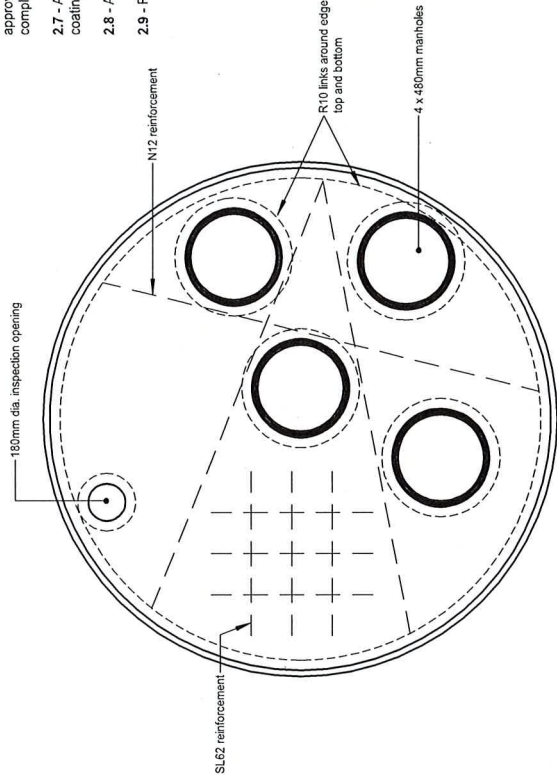

**Lid Plan**  
Scale 1:25

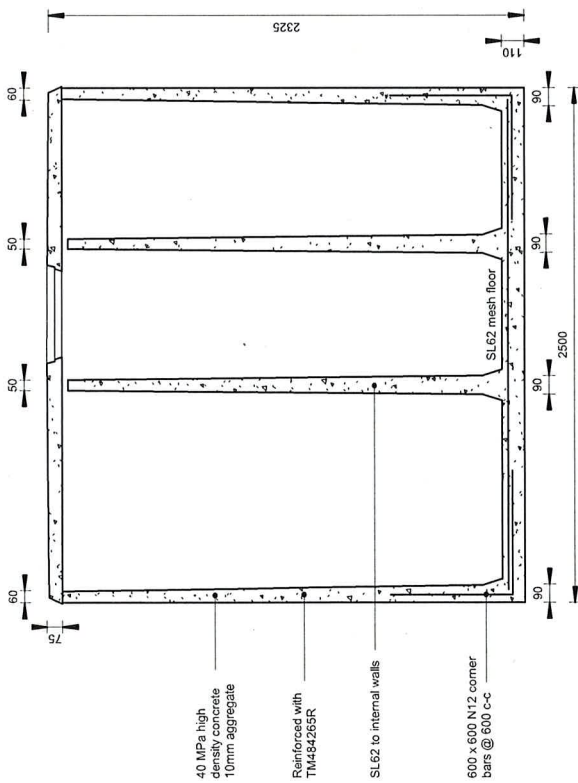

**Section A**  
Scale 1:25

