



# Safety Alert 001/09

The actions specified are mandatory in accordance with NSW Health Policy Directive PD2006\_102

17 February 2009

## PEEP Valve, Expiration Diverter Assembly

### Distributed to:

- Chief Executives

### Action required by:

- Chief Executives
- Directors of Clinical Governance
- Directors of Clinical Operations
- Directors of Anaesthetics
- Directors of ICU/ Critical Care
- Directors of Emergency Department

### For response by:

- Directors of Clinical Governance

### We recommend you also inform:

- Drug and Therapeutic Committees
- Directors of Nursing
- Medical staff
- Nurse Unit Managers
- Theatre Managers

### Deadline for completion of action

17th March 2009

### Expert Reference Group

#### Content reviewed by:

- ICCMU
- ICU Equipment Managers
- Intensive Care Taskforce
- Sydney West Area Health Service

### Quality and Safety Branch

NSW Department of Health  
Tel. 02 9391 9200

Fax. 02 9391 9556

Email

[quality@doh.health.nsw.gov.au](mailto:quality@doh.health.nsw.gov.au)

Website

<http://www.health.nsw.gov.au/quality/sabs/index.html>

### Background

NSW Health has recently been notified of a patient's misadventure due to incorrect assembly of a PEEP Valve. It has been noted that the Peep Valve can be assembled with the Silicone Ring that is part of the Peep Valve Expiration Diverter. When this Ring is inserted into the incorrect spot it will impede the PEEP valve from working correctly. This error can occur because the Silicone Ring is shaped to fit perfectly in both the correct (in the Peep Valve Diverter) and incorrect (in the Peep Valve) position [see diagrams below]. When this error occurs the expiration phase of ventilation is impaired leading to high intra- thoracic pressures.

### Actions

- It is recommended that a laminated instruction sheet be located close to where the equipment is being assembled, and testing of equipment (including resuscitation bag, PEEP valve and diverter) occurs prior to use.
- Checking of resuscitation equipment should be undertaken regularly by appropriately skilled personnel, to ensure equipment is assembled and functioning correctly.

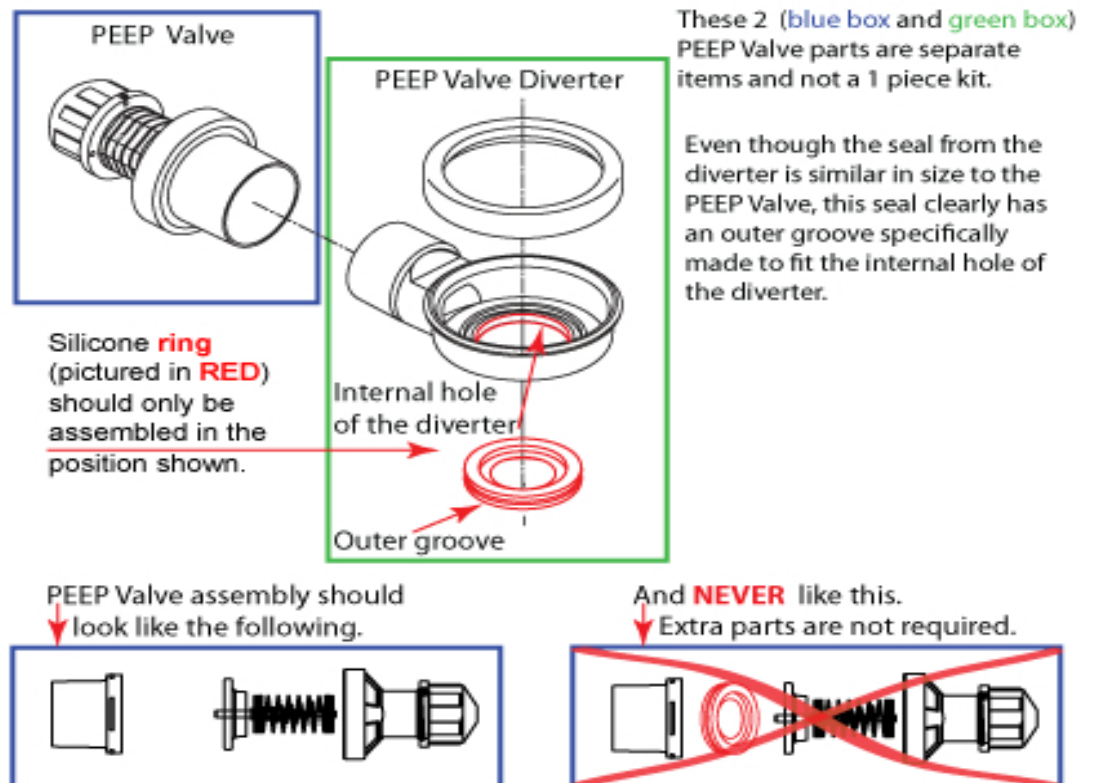

**Additional Information:** Videos produced by Sydney West Health Service showing correct and incorrect assembly are available at:

**Correct Assembly:** [http://www.health.nsw.gov.au/resources/quality/sabs/other/peep\\_v\\_correct\\_function.MPG](http://www.health.nsw.gov.au/resources/quality/sabs/other/peep_v_correct_function.MPG)

**Incorrect Assembly:** [http://www.health.nsw.gov.au/resources/quality/sabs/other/peep\\_v\\_no\\_expiration.MPG](http://www.health.nsw.gov.au/resources/quality/sabs/other/peep_v_no_expiration.MPG)

### Action required by Area Health Services

- Laminated instructions to be located in all areas where assembly occurs.
- Checking of resuscitation equipment is undertaken by skilled staff prior to use.