



# Certificate of Accreditation

## Sewage Management Facility

### Septic Tanks and Collection Wells

*This Certificate of Accreditation is issued by the Secretary of the NSW Ministry of Health pursuant to Clause 41(1) of the Local Government (General) Regulation 2005.*

*Manufacturer: **Orenco Systems Incorporated***

*Of: **814 Airway Ave, Sutherlin, Oregon, USA, 97479***

*The Orenco PDCPD Common Effluent Drain Pre-treatment Tank as described in the following Schedule has been accredited as a sewage management facility for use in single domestic premises in NSW.*

*A/Director, Environmental Health  
for Secretary (delegation PH335)*

**Issued: 9 April 2021**

**Certificate No: CED001**

**Expires: 31 December 2024**



## ***Accreditation Schedule***

*The Certificate of Accreditation applies to the following  
Septic Tanks and Collection Wells*

Model	Description	Size
CED Pre-Treatment Tank	PDCPD spherical moulded tank of Dicyclopentadiene HPR 2102 polymer injection moulded, with partition, lid, access cover. Tank lid burial depth is restricted to 1.5 m	3800 L

**General Notes:**

**Tank Volumes:**  
 Total Volume: 1,233 gal / 4,630 Liters±  
 Operating Volume: 1,006 gal / 3,808 Liters± @ 1200mm  
 Unit volume at typical Operating Depth: 2.98 L / mm±

**Installation:**

Installation, bedding, compaction, etc., shall be in "strict" compliance with the manufacturers standards and state or local rules and or guidelines. All tanks shall be set level on a minimum 100 millimeters thick compacted sand or approved granular bedding overlying a firm uniform base. The base shall be stable and uniform in order to ensure equal bearing across the tank bottom. Installations with 450 millimeters or less of ground cover may require additional buoyancy considerations as described in the manufacturers instructions. A minimum cover of 300 millimeters is required over the tank in areas subject to occasional light wheel loads.

**Test:** Tanks shall be tested and certified watertight per manufacturers recommendations and or any prevailing rules or guidelines, whichever is more restrictive.

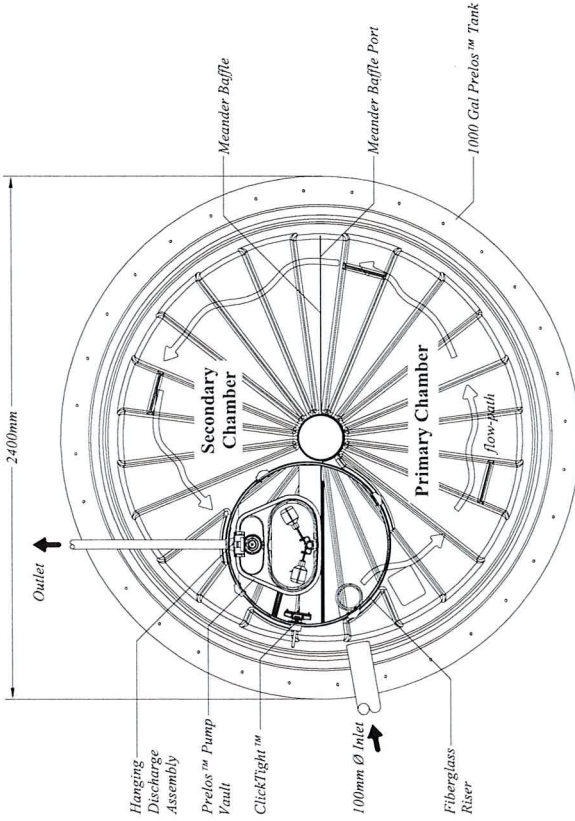
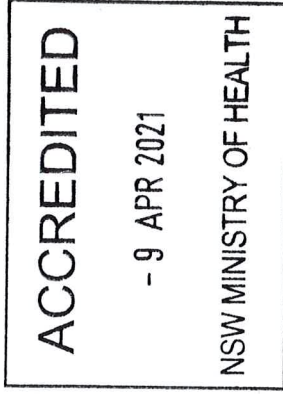

**Top Detail**  
 Scale: 1:24

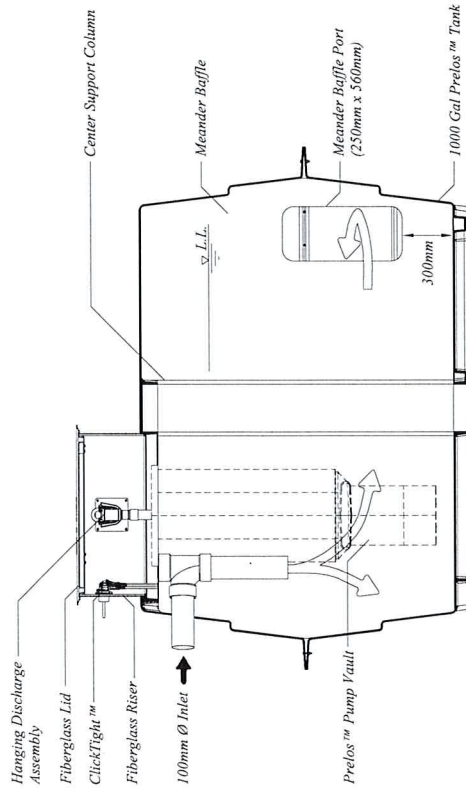

**Side Detail**  
 Scale: 1:24

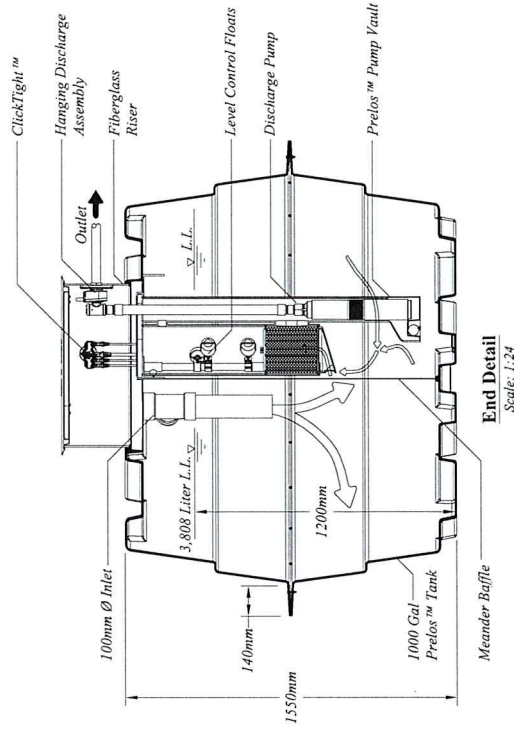

**End Detail**  
 Scale: 1:24

Inside Height Millimeters / Inches	Volume U.S. Gallons / Liters
1500 / 60	1217 / 4606
1350 / 54	1124 / 4254
1200 / 48	1006 / 3808
1050 / 42	881 / 3335
900 / 36	744 / 2816
750 / 30	601 / 2275
600 / 24	460 / 1741
450 / 18	324 / 1226
300 / 12	200 / 757
150 / 6	83 / 314
0	0

© Orenco Systems, Inc. This Product Configuration Drawing, or portions or all of this Product Configuration Drawing, shall be used in conjunction with the manufacturer's instructions and integrated with the site-specific layout and configuration of a system by its designer.



Orenco Prelos™ Processor  
 DESIGN AID

Drawn By: BAS	Scale: 1:24
Reviewed By: BH	Sheet: 1 OF 1
File Name: PRELOS 1000 - INTERNATIONAL.DWG	Rev: 1.3 Date: 3/02/2020

DEPARTMENT OF HEALTH

1000 1000

WOCKEDED